

PHT-409N HIGH FREQUENCY SUPER TWEETER

GENERAL SPECIFICATIONS

Size	: 88x148.5mm 3.4x5.8 Inch
Rated Impedance	: 8 ohm
Power Handling Capacity	: 40 W(rms)
Sensitivity 1W@1m	: 99.0 dB
Operating Bandwidth	: 3500 - 20000 Hz.
Nominal Coverage	: (H x V) -5 dB, 90°CX 40°C
Throat Diameter	: 25.00mm 1 Inch
Recommended Crossover	: 2nd . Order or higher

THIELE -SMALL PARAMETERS

Resonance Frequency	Fs	2644.0 Hz
DC Resistance	Re	8.1 ohm
Mechanical Q Factor	Qms	1.693
Electrical Q Factor	Qes	3.747
Total Q Factor	Qts	1.166
Voice -coil inductance @ 1kHz	Le	0.04 mH

PHYSICAL INFORMATION

Horn Material : A.B.S with Glass fille
: Black Poly carbonate

Finished : Paint Black

Diaphragm Material : Titanium

Terminal : Plated terminal

Magnet : Neodymium

Voice coil Material : Round Copper wire

Unit Weight : 0.22 Kgs (0.484Lb)/pcs

Gross Weight : 0.3 kgs (0.66Lb)/pcs

Packing Dimension WxLxH (mm) : 310 X 400 X 250
(12.2in X 15.7in X 9.8in)
1.09 Cu.Ft. /20 pcs

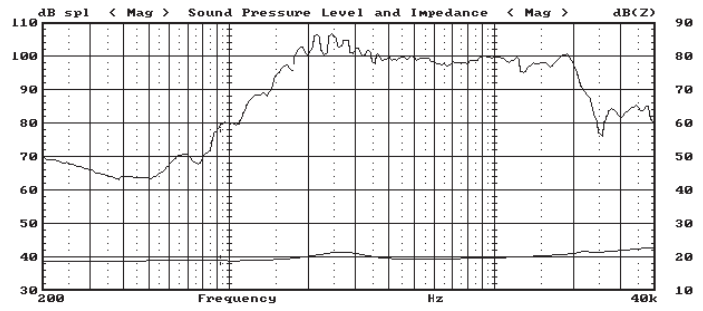
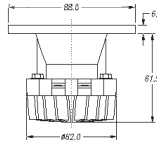
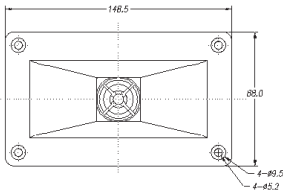

PHT-410 HIGH FREQUENCY SUPER TWEETER

GENERAL SPECIFICATIONS

Usable Frequency Range	: 2K~15K Hz
Power Rating	: 20 W
Average Sensitivity (1w/1m)	: 105 dB
Impedance	: 8 ohm
Voice coil Diameter	: 25.4 mm (1 in)
Voice coil Material	: Round Copper Wire
Horn Material	: A.B.S. With Glass Filled Black Polycarbonate
Diaphragm	: Phenolic Resin
Cut off Frequency	: 780 Hz
Mouth Width	: 110 mm (4.3 in)
Mouth Height	: 110 mm (4.3 in)
Mouth Depth	: 118 mm (4.6 in)
Mounting Flange Thickness	: 4.75 mm (0.18 in)
Mounting Holes	: 4x5 mm (0.2 in)

